

# Foul drainage assessment form (FDA1)

**Please note:** this form should be used for planning related queries only and cannot be used when applying for an environmental permit.

## APPLICANT DETAILS

Name

Address

Telephone No/e-mail

Simon Smith Design  
20 Budle Close, Blyth  
Northumberland,  
NE24 5DS

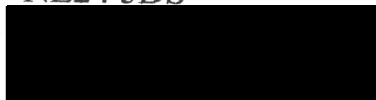

Northumberland National Park  
Authority  
Planning Department  
Received  
15 DEC 2015

This form should be used to establish whether non-mains drainage, either a new system or connection to an existing system, would be acceptable. Your answers to the following questions will be taken into consideration. It is important that you provide full and accurate information. Failure to do this may delay the processing of your application.

**You must provide evidence that a connection to the public sewer is not feasible.** Other than very exceptionally, providing non-mains drainage as part of your Planning or Building Regulation application will not be allowed unless you can prove that a connection to the public sewer is not feasible. Non-mains drainage systems are not considered environmentally acceptable in publicly sewered areas. Please note that the existence of capacity or other operating problems with the public sewer are not valid reasons for non-connection where this is reasonable in other respects.

Where connection to the public sewer is feasible, agreements may need to be obtained either from owners of land over which the drainage will run or the owners of the private drain.

Government guidance contained within DETR Circular 03/99/ WO 10/99 'Planning requirements in respect of the use of non-mains sewerage incorporating septic tanks in new development' gives a hierarchy of drainage options that must be considered and discounted in the following order:

- 1 Connection to the public sewer
- 2 Package sewage treatment plant (which can be offered to the Sewerage Undertaker for adoption)
- 3 Septic Tank
- 4 If none of the above is feasible a cesspool

You must respond to all the following questions, if you wish to submit additional information please do so, marked clearly "Additional Information". In some cases you will be required to provide a further assessment in accordance with the requirements of DETR Circular 03/99/ WO 10/99 (see Guidance Note 1).

### Mains connection

	YES	NO
Have you provided a written explanation of why connection to the mains sewer is not feasible with this form? <i>NO MAINS AVAILABLE</i>	<input checked="" type="checkbox"/>	
<i>This should include a scaled map showing the nearest mains connection point - check with your local sewerage undertaker.</i>	<input checked="" type="checkbox"/>	

### Non-mains connection

Please provide a plan with dimensions that clearly shows the location of the whole system in relation to the proposed development and the position of the key elements e.g. septic tank, drainage fields and points of discharge.

1. Existing system	YES	NO
Do you intend to use an existing non-mains foul drainage system?		<input checked="" type="checkbox"/>
If YES, does the system already have an Environmental Permit issued by the Environment Agency? (In the case of a cesspool write N/A) Please provide Environmental Permit reference number.....		

2. Discharge	YES	NO
Do you propose to use a cesspool? If yes go to Q4		<input checked="" type="checkbox"/>
Do you intend to use a system that discharges solely to watercourse? (see Guidance Note 2) If yes go to Q8.		
Alternatively, will all, or any part of, the discharge go to soakaway? (see Guidance Note 2) - this would include systems that combine a soakaway with a high level overflow to watercourse? If yes go to Q3.		
Have you considered having your system adopted by the sewerage undertaker? (See Guidance Note 6).		

3. Water abstraction	YES	NO
Do you receive your water from the public mains supply? If yes go to Q5	<input checked="" type="checkbox"/>	
If not, where do you get your water supply from?		

4. Cesspools (For methods other than cesspools write N/A)	YES	NO
Have you provided written justification for the use of a cesspool in preference to more sustainable methods of foul drainage disposal? (see Guidance Note 3)		

5. Ground Conditions (For cesspools write N/A)	YES	NO
Have you submitted a copy of the percolation test results with this form (see Guidance Note 4)?	<input checked="" type="checkbox"/>	
If NO please explain the justification for not undertaking or submitting these tests.		
Is any part of the system in land which is marshy, water logged or subject to flooding?		<input checked="" type="checkbox"/>
Will the soakaway be located on artificially raised, made-up ground or ground likely to be contaminated? If yes please provide details as additional information.		<input checked="" type="checkbox"/>
Have you submitted the results of a trial hole at the site to establish that the proposed drainage field will be above any standing groundwater (see Guidance Note 5)?	<input checked="" type="checkbox"/>	

6. Available Land	YES	NO
Is the application site plus any available area for a soakaway less than 0.025 hectares (250m <sup>2</sup> )? <i>= TRIAL HOLES FOR PERCOLATION TEST DID NOT REVEAL THE WATER TABLE. (1.2m DEEP)</i>	<input checked="" type="checkbox"/>	



**7. Siting of drainage field/soakaway discharge from a septic tank or package treatment plant or other secondary treatment..**

*You may need to make local enquiries to get a full answer to these questions.*

	YES	NO
Will it be at least <b>10m</b> from a watercourse, permeable drain or land drain?	<input checked="" type="checkbox"/>	<input type="checkbox"/>
Will it be at least <b>50m</b> from any point of abstraction from the ground for a drinking water supply (e.g. well, borehole or spring)? <i>This includes your own or a neighbour's supply.</i>	<input checked="" type="checkbox"/>	<input type="checkbox"/>
Are there any drainage fields/soakaways within <b>50m</b> ? <i>This includes any foul drainage discharge system (other than the subject of this application) on either your own or a neighbour's property..</i>	<input type="checkbox"/>	<input checked="" type="checkbox"/>
Will it be at least <b>15m</b> from any building? <i>(8m)</i>	<input type="checkbox"/>	<input checked="" type="checkbox"/>
Will there be any water supply pipes or underground services within the disposal system, Other than those required by the system? <i>(For cesspools write N/A)</i>	<input type="checkbox"/>	<input checked="" type="checkbox"/>
Will there be any access roads, driveways or paved areas within the disposal area? <i>(For cesspools write N/A)</i>	<input type="checkbox"/>	<input checked="" type="checkbox"/>

**8. Siting of treatment plant, septic tank or cesspool**

	YES	NO
Is it at least <b>7m</b> from the habitable part of a building?	<input checked="" type="checkbox"/>	<input type="checkbox"/>
Will there be vehicular access for emptying within <b>30m</b> ?	<input checked="" type="checkbox"/>	<input type="checkbox"/>
Can the plant, tank or cesspool be maintained or emptied without the contents being taken Through a dwelling or place of work?	<input checked="" type="checkbox"/>	<input type="checkbox"/>

*NB: ONE PLANT TO SERVE BOTH PROPERTIES.*

**9. Expected flow**

Please estimate the total flow in litres per day (see Guidance Note 4).	<b>180</b>
---	------------

**10. Maintenance**

How do you propose to maintain the system? If the development consists of multiple units discharging to a shared plant, please include details of who will be responsible for the future maintenance of the system and any related legal agreements.

\* THE SYSTEM WILL BE EMPTIED ONCE PER YEAR.

\* THE OWNER WILL BE RESPONSIBLE - IE. MR CAMBELL.

**Declaration**

I declare that the above information is factually correct.

Name	Signature	Date
<i>Simon Smith</i>		<i>10.12.15</i>

Northumberland National Park  
Authority  
Planning Department  
Received

15 DEC 2015

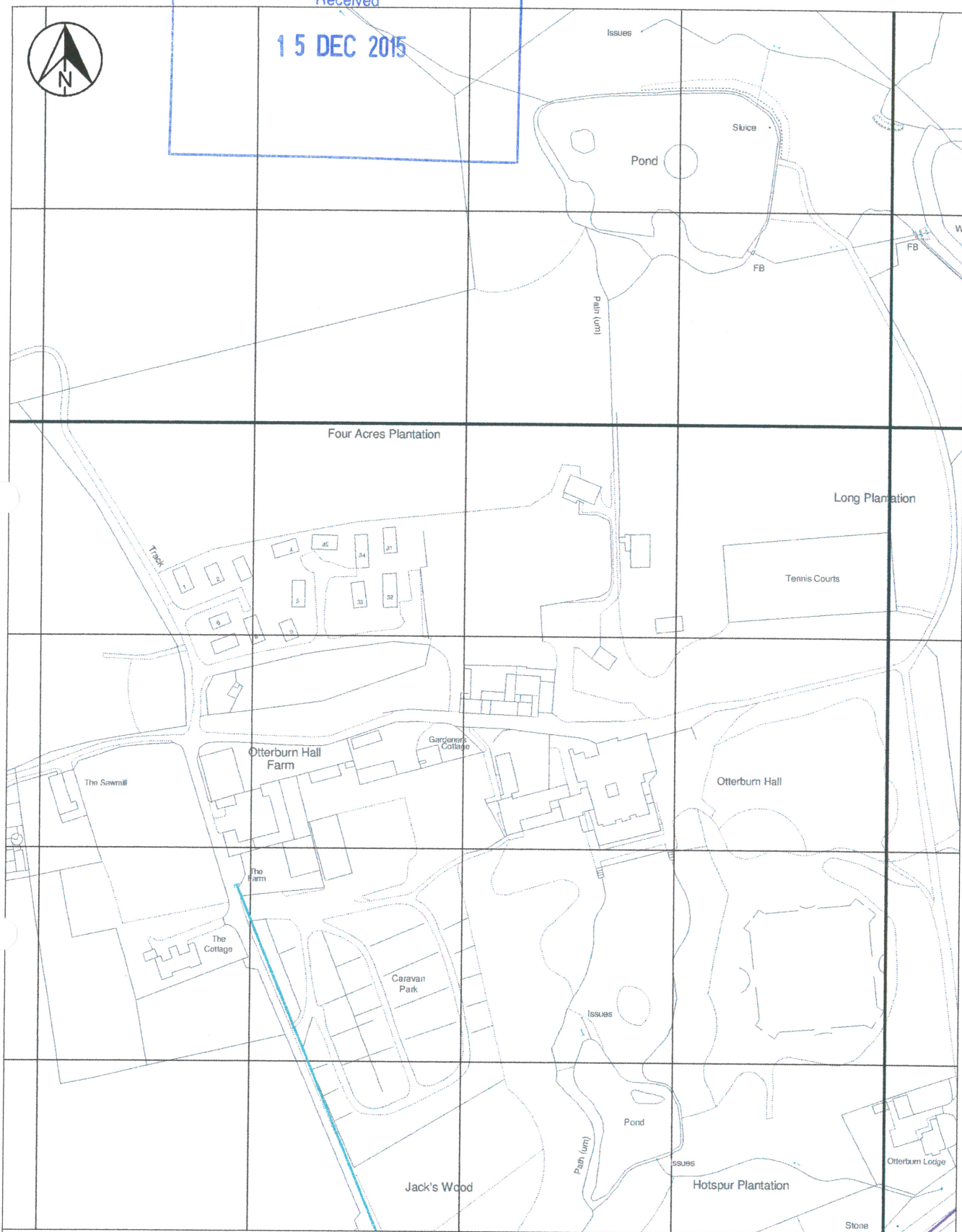

User : WOodd1

Date : 25/11/2015 15:09:06

Title :

Map Sheet : NY8894SW

Centre Point : 388309,594408

Paper / Scale : A4@1:2500

The material contained on this plot has been reproduced from an Ordnance Survey map with permission of the controller of H.M.S.O. Crown Copyright Reserved. Licence No. WU298506  
The information shown on this plan should be regarded as approximate and is intended for guidance only. No Liability of any kind whatsoever is accepted by Northumbrian Water, its servants or agents for any omission. The actual position of any water mains or sewers shown on the plan must be established by taking trial holes in all cases. In the case of water mains Northumbrian Water must be given two working days notice of their intention to excavate trial holes. Private connections are not shown but their presence should be anticipated.  
WARNING...Where indicated on the plan there could be abandoned asbestos cement materials or shards of pipe. If excavating in the vicinity of these abandoned asbestos cement materials, the appropriate Health & Safety precautions should be taken. Northumbrian Water accepts no liability in respect of claims, costs, losses or other liabilities which arise as the result of the presence of the pipes or any failure to take adequate precautions. Emergency Telephone Number: 0345 717 1100

25 m





15 DEC 2015

OTTERBURN HALL							
Reading	Test hole 1		Test hole 2		Test hole 3		
	Time (mins)	Level(mm)	Time (mins)	Level(mm)	Time (mins)	Level(mm)	
1	0	228	0	228	0	228	
2	30	55	30	60	30	60	
3	60	-	60	-	60	-	
4	90		90		90		
5	120		120		120		
6	150		150		150		
7	180		180		180		
8	210		210		210		
9	240		240		240		
10	270		270		270		
11	300		300		300		
12	330		330		330		
13	360		360		360		
		75mm @ 39m		75mm @ 41m		75mm @ 41m	
Vp		15.6		16.4		16.4	
f		32		30		30	



(9.12.15)