

**KEY:**

- Asphalt (See Patrick Parsons detail).
- Tar spray & chippings for vehicle access & parking bays, See Patrick Parsons detail, colours: T1 = honey/pink, T2 = light grey tones.
- Tar spray & chippings for pedestrian access, See Patrick Parsons detail, colours: T1 = honey/pink, T2 = light grey tones.
- Lafarge Tarmac 'Ulticolour', Buff Quartzite, pedestrian access (See Patrick Parsons detail).
- Lafarge Tarmac 'Ulticolour', clear - natural - vehicular access (See Patrick Parsons detail).
- Natural sandstone flags (See Patrick Parsons detail).
- Reclaimed stone flags (See Patrick Parsons detail).
- Whinstone setts (See Patrick Parsons detail).
- Loose gravel over compacted sub-base, pedestrian access (See Patrick Parsons detail).
- Compacted whinstone, vehicular access (See Patrick Parsons detail).
- Compacted whinstone footpath (See Patrick Parsons detail).
- Reinforced whinstone [plastic grid] (See Patrick Parsons detail).

**NOTES:**

- Play spaces (YHA garden and between car parks) to have bark chippings or grass mat as primary safety surface (see dwg. SIL-PP-00-ZZ-DR-C-280).

Edging materials: (see dwgs. SIL-GK-00-ZZ-DR-L-8405 & 8506)

Rev.	Date	description
P01	07-05-15	Initial draft.
P02	22-05-15	Differentiation made between vehicular and pedestrian surfacing types.
P03	28-05-15	References added to key.
P04	26-06-15	Minor changes to key text, layout reconciled.
C01	23-09-15	VE changes incorporated.
C02	30-09-15	Passing place added to car park access route.
C03	09-10-15	Additional VE changes following design team review.
C04	23-11-15	Finalised sub-station position shown. Landscaping adjusted to suit. No dig construction to eastern parking bays omitted.

Client <b>NNPA / YHA</b>			
Project <b>The Sill, Once Brewed, Northumberland</b>			
Title <b>Hard surfacing - Central</b>			
Drawn	Checked	Date	Scale@A1
<b>PB/QV</b>	<b>PB</b>	<b>05/15</b>	<b>1:250</b>
Drawing No.	Status	Revision	
<b>SIL-GK-00-ZZ-DR-L-8401</b>	<b>A</b>	<b>C04</b>	

**GLENKEMP**  
 LANDSCAPE EIA ■■■ PLANNING ECOLOGY

Design Works, William Street, Felling on Tyne, NE10 0JP  
 Telephone: 0191 485 2495 Fax: 0191 489 2868  
 E mail: planconsult@glenkemp.co.uk

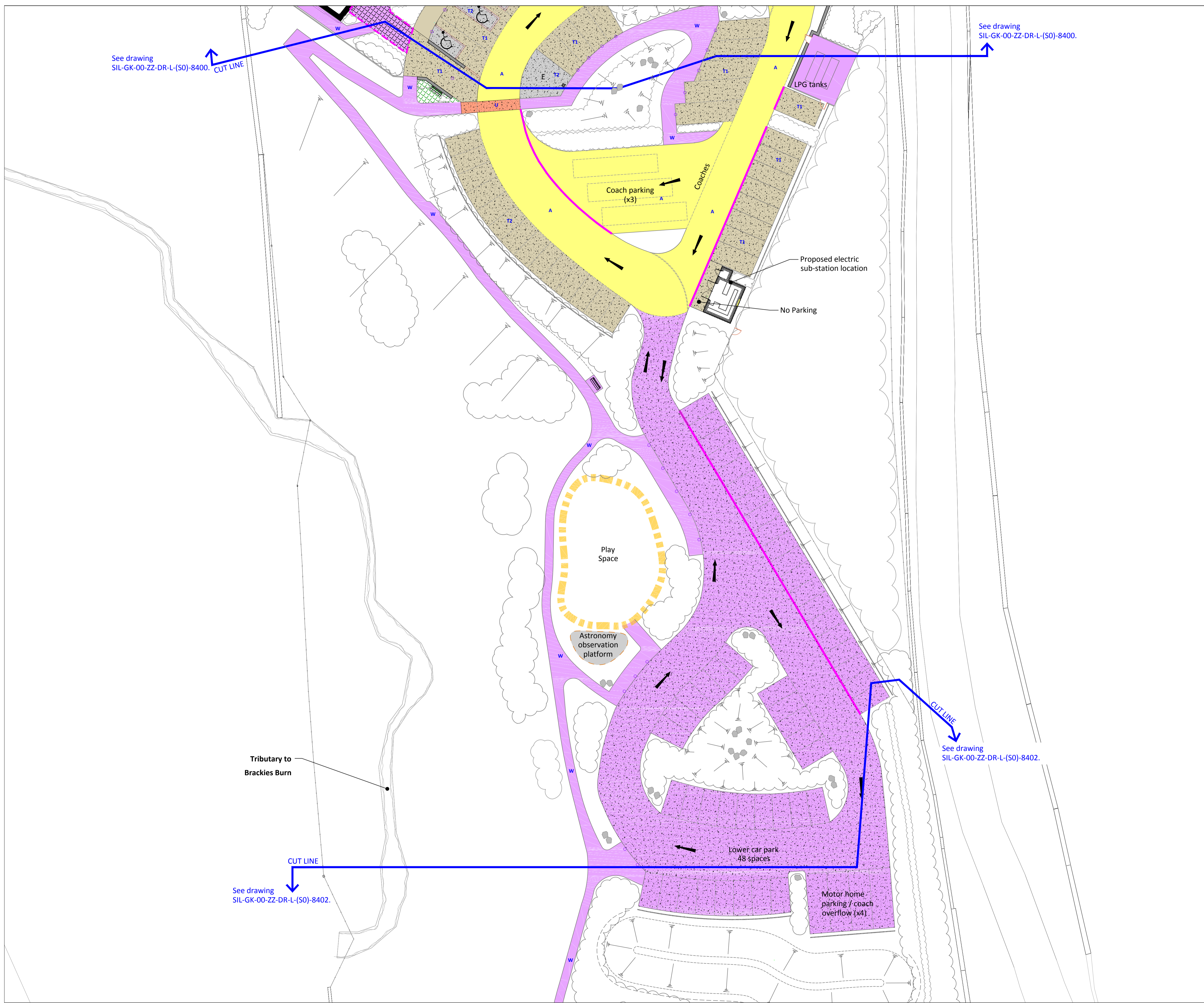

See drawing SIL-GK-00-ZZ-DR-L-(S0)-8400. CUT LINE

See drawing SIL-GK-00-ZZ-DR-L-(S0)-8400.

See drawing SIL-GK-00-ZZ-DR-L-(S0)-8402. CUT LINE

See drawing SIL-GK-00-ZZ-DR-L-(S0)-8402. CUT LINE

Tributary to Brackies Burn

Coach parking (x3)

Coaches

Proposed electric sub-station location

No Parking

Play Space

Astronomy observation platform

Lower car park 48 spaces

Motor home parking / coach overflow (x4)

LPG tanks