

POLE CARRYING POWER BATTERY TO COVER GATE RE-POSITIONED. FINAL POSITION TO BE AGREED WITH PROVIDER.

service access road

NEW SERVICE ACCESS ROAD FORMED FORM 3.5M WIDE WITH GRASSCRETE (OR GRASS) REINFORCED CONCRETE WITH VOID INFILLED IN TOP SOIL AND SEEDED.

VESTIBULE AREA TO BE GLAZED WALLS AND ROOF WITH TILED FLOOR

ACTIVITY BUILDING TO BE TIMBER FRAMED TIMBER CLAD WITH EXPOSED ESR IN METAL ON EXPOSED TIMBER TRUSSES

NEW FAN DRAINAGE TO BE USED FROM EXISTING MANHOLE TO NEW TREATMENT PLANT. (SEE DETAILS)

EXISTING CORSE TO REMAIN.

ROAD DESIGN AND WIDTH TO COMPLY WITH LOCAL AUTHORITY ROADS DEPT. AND ALL WIDTHS AND TURNING CIRCLES AGREED TO THEIR SATISFACTION.

EXTERNAL WALLS TO HAVE STONE FINISH ON TIMBER FRAME

STEEL COLUMNS TO SUPPORT EXPOSED GLUCOLAM BEAMS TO ROOF.

EXISTING STONE WALL SHOWN DOTTED TO BE RE-BUILT IN NEW POSITION

PAVED AREA FOR GROUP ASSEMBLY (DETAILS TO FOLLOW)

GRASSED AREA.

NEW FAN DRAINAGE LINE TO NEW TREATMENT PLANT.

TIMBER FRAMED EXPOSED WALL FOR OIL TANK AND GENERATOR.

New M.H.

New M.H.

EXISTING DRAINAGE LINE MADE OBSOLETE AND PIPEWORK SEALED AS REQUIRED.

EXISTING STONE WALL TO BE RE-BUILT AS SHOWN.

EXISTING FAN DRAINAGE LINE DISCONNECTED AND MADE OBSOLETE.

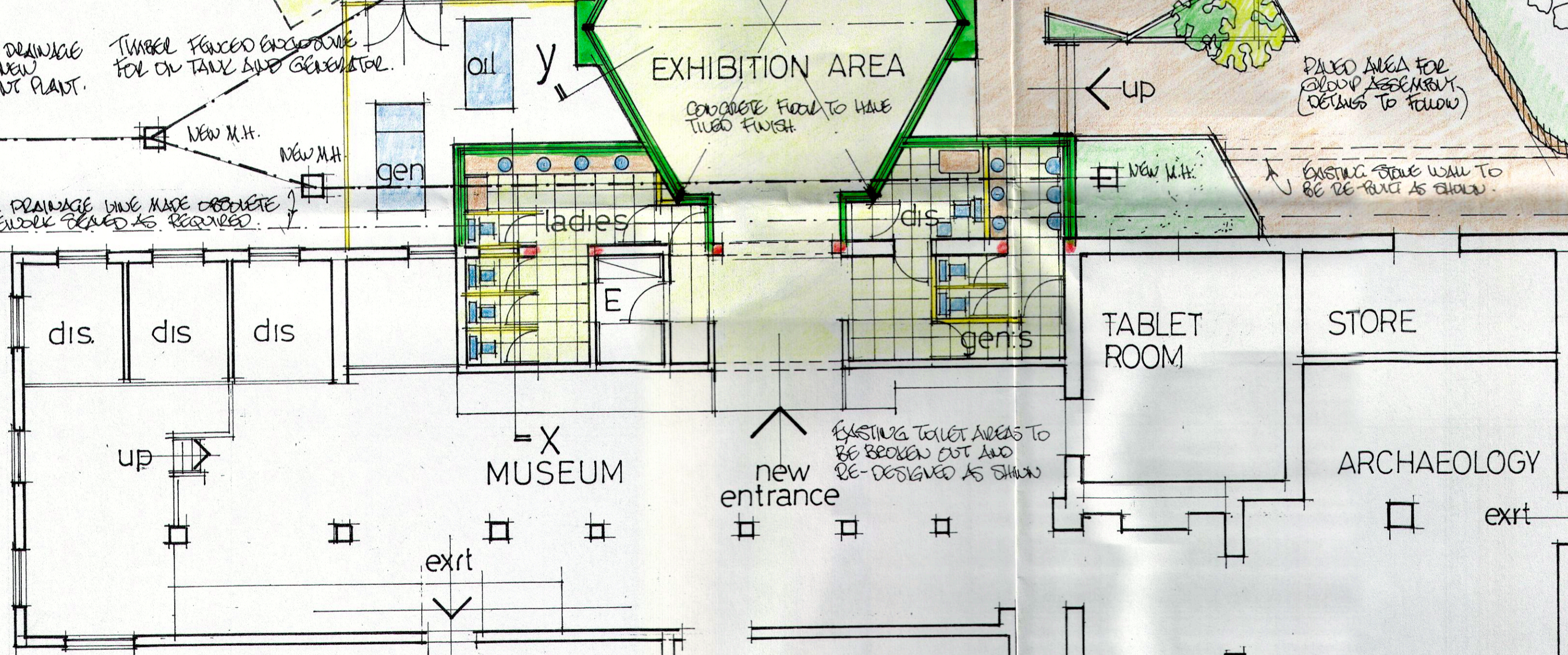

PLAN AS PROPOSED

1:100

VINDOLANDA CHESTERHOLM MUSEUM

Andrew R Hamilton

Building & Design Consultant

71 NORTH DRIVE, TROON, Ayrshire KA10 7DN

Tel: 01292 312602 Mobile: 07709206248 Email: andy.hamilton@bt.com