

# GROUND FLOOR

### NOTES

COPYRIGHT !!!!!!  
 ALL RIGHTS TO THIS DRAWING ARE ABSOLUTELY THE DESIGNERS AND FORM OF TRANSFER, DUPLICATION, COPYING IN ANY MATERIAL FORM WITHOUT THE AUTHOR'S PERMISSION WILL BE TANTAMOUNT TO COPYRIGHT INFRINGEMENT AS WELL AS AN INTELLECTUAL PROPERTY WHICH WILL ULTIMATELY LEAD TO LAWSUIT.

- 1 All dimension, levels, etc.. to be checked before any work is commenced.
- 2 Figure dimensions to be taken, scaling of drawings is not permitted.
- 3 Any errors, ambiguity or queries relating to drawing are to be referred to the architect for clarification before any work is commenced.
- 4 No alterations or amendments shall be made to the drawing without the work illustrated therein without reference to the architect.
- 5 Reinforced concrete works to structural engineers design.
- 6 Finishes/painting to architects finishes/color schedule.



ARCHITECTS AND INTEGRATED BUILDING CONSULTANTS  
 PLOT NO 1925, SAHIVE AREA, SOLIWEZ  
 Mobile: +260 961022414  
 Email: Archipoc5@gmail.com

PROJECT TITLE  
 PROPOSED REVISION  
 A. HICKMAN'S HOUSE

SHEET TITLE  
 REVISED GROUND FLOOR PLAN

DESIGNED BY: J.M.SAMUNETE	DRG NO.
CHECKED:	SHEET NO. 000
DATE Nov, 2015	
SCALE 1:50 at A3 paper	

Northumberland National Park Authority  
 Planning Department  
 Received  
 11 OCT 2016



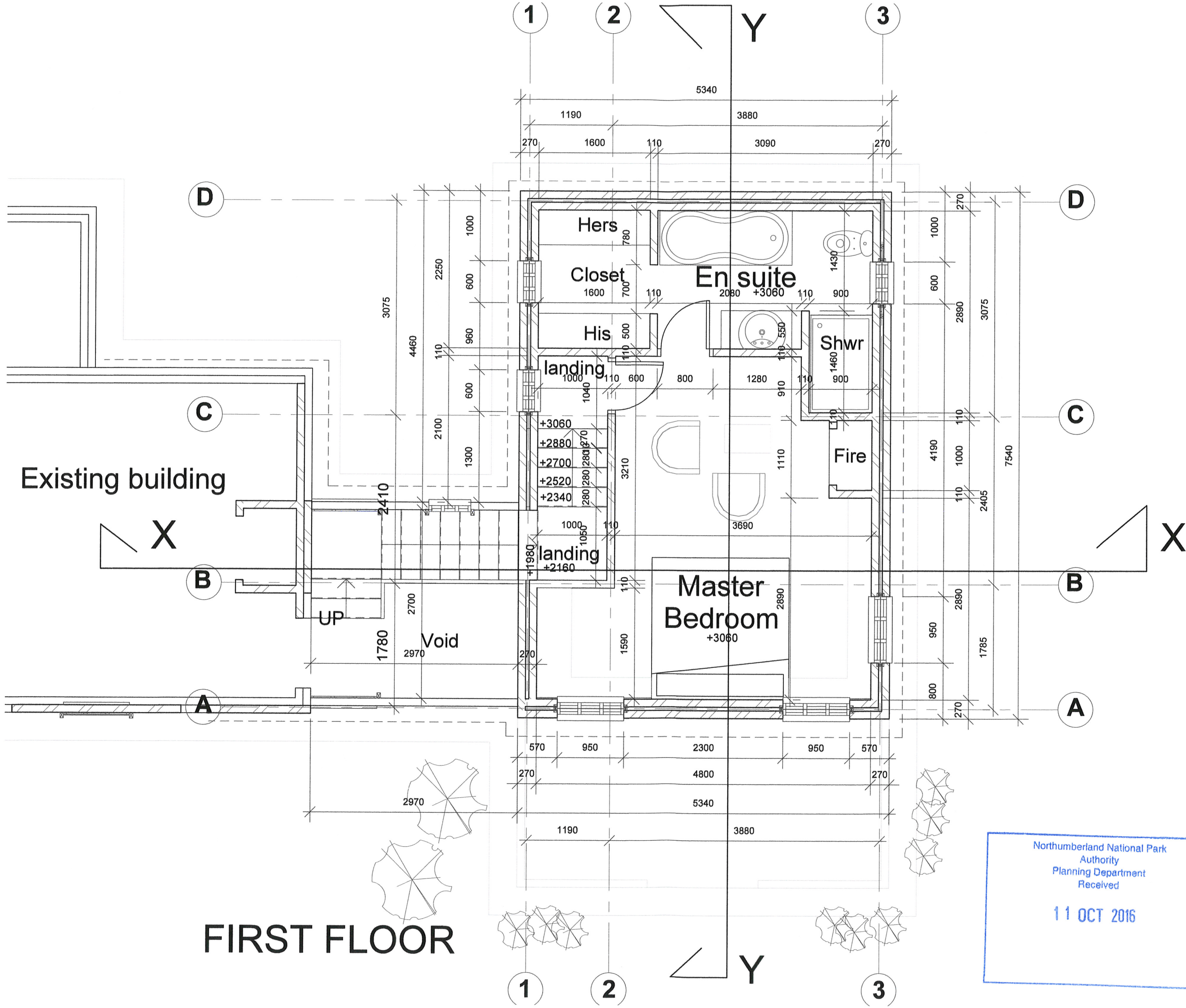

# FIRST FLOOR

NOTES

COPYRIGHT !!!!!!!  
 ALL RIGHTS TO THIS DRAWING BE ABSOLUTELY THE DESIGNERS. AN FORM OF TRANSFER, DUPLICATION, COPYING IN ANY MATERIAL FORM WITHOUT THE AUTHOR'S PERMISSION WILL BE TANTAMOUNT TO COPYRIGHT INFRINGEMENT AS WELL AS AN INTELLECTUAL PROPERTY WHICH ULTIMATELY LEAD TO LAWSUIT.

- 1 All dimension, levels, etc.. to be checked before a work is commenced.
- 2 Figure dimensions to be taken, scaling of drawings is not perm
- 3 Any errors, ambigu or queries relating to drawing are to be refe to the architect for clarification before a work is commenced
- 4 No alterations or amendments shall be made to the drawing the work illustrated therein without refere to the architect
- 5 Reinforced concrete works to structural engineers design
- 6 Finishes/painting to architects finishes/color schedu



ARCHITECTS AND INTEGRATED BUILDING CONS  
 PLOT No 1325, SAVIYE AREA, SOLIWEZ  
 Mobile: +260 991022414  
 Email: Archpec5@gmail.com

PROJECT TITLE  
 PROPOSED REVISION  
 A. HICKMAN'S HOUSE

SHEET TITLE  
 REVISED FIRST FLOOR

Northumberland National Park  
 Authority  
 Planning Department  
 Received  
 11 OCT 2016

DESIGNED BY: J.M.SAMUNETE	DWG NO.
CHECKED	SHEET NO. 001
DATE NOV, 2015	
SCALE 1:50 at A3 paper	