

NOTES

ALL ELECTRICAL WORK IS TO BE DESIGNED, INSTALLED, INSPECTED AND TESTED IN ACCORDANCE WITH BS 7671 (I.E.E. WIRING REGULATIONS 17TH EDITION). THE WORKS ARE TO BE UNDERTAKEN BY AN INSTALLER REGISTERED UNDER A SUITABLE ELECTRICAL SELF-CERTIFICATION SCHEME, OR ALTERNATIVELY BY A SUITABLY QUALIFIED PERSON, WITH A CERTIFICATE OF COMPLIANCE PRODUCED BY THAT PERSON TO BUILDING CONTROL ON COMPLETION OF THE WORKS.
CENTRAL HEATING TO BE IN ACCORDANCE WITH CLIENTS REQUIREMENTS.
ALL NEW RADIATORS TO BE FITTED WITH SUITABLE THERMOSTATIC VALVES, & PIPEWORK SUITABLY INSULATED.
USE SUITABLE SAFETY GLAZING IN 'CRITICAL AREAS' TO BS 6206 1981
1/20 OF FLOOR AREA RAPID VENTILATION TO ALL HABITABLE ROOMS

MAIN ROOF:

INTERLOCKING CONCRETE ROOF TILES. ANTHRACITE DOUBLE ROMAN ON 50mm X 25mm BATTENS. ON TYVEK SUPRO UNDERLAY ON PREFABRICATED ROOF TRUSSES @ 600mm CRS.
PITCH 22.5 DEGREES, TO CP112 AND SUBSEQUENT CODES OF PRACTICE.
TO BE DESIGNED, MANUFACTURED AND SUPPLIED BY SPECIALIST WITH ALL CALCS. SUPPLIED TO LOCAL AUTHORITY BUILDING CONTROL.
ALL BRACING FIXED AS RECOMMENDED BY TRUSS DESIGNER.
SECURED TO 100mm X 50mm HEADBINDER BY GALV. MS CLIPS.
USE 100mm X 38mm DIAGONAL TIES.
ROOF INSULATION TO BE LAID IN TWO 150mm LAYERS AT RIGHT ANGLES TO EACH OTHER.
12.5mm PLASTERBOARD AND SKIM FINISH.
(U-VALUE ACHIEVED MAXIMUM 0.16 W/m²K)

WALLS:

20mm WESTERN RED CEDAR SHIPLAP BOARDING ON 38mm x 25mm BATTENS AT 600mm CTS. ON BUILDING PAPER TO BS 4016. ON 9.5mm PLY SHEATING
WITH 85mm THK. KINGSPAN KOOLTHERM K12 WITHIN 125mm x 50mm TIMBER STUDS @ 600mm CTS.
VISQUEEN VAPOUR CHECK 500 GAUGE. 12.5mm PLASTERBOARD AND SKIM.
(U-VALUE ACHIEVED MAXIMUM 0.28 W/m²K)
TO BE DESIGNED, MANUFACTURED AND SUPPLIED BY SPECIALIST.
WITH ALL CALCS. SUPPLIED TO LOCAL AUTHORITY BUILDING CONTROL.

SUSPENDED TIMBER FLOOR:

22mm THICK FLOORING WEYROC ON 50mm X 150mm JOISTS C16 @ 400mm CRS.
WITH 65mm THK. KINGSPAN T70 INSULATION BETWEEN THE JOISTS. (U-VALUE ACHIEVED MAXIMUM 0.22W/m²K)
SUPPORTED ON BATTENS. JOISTS SUPPORTED BY 103mm HONEYCOMBED SLEEPER WALLS. WITH DPC UNDER 100mm x 50mm WALL PLATE. WITH 100mm SITE CONCRETE ON DPM LINKED TO DPC IN BLWK. ON 50mm SAND BLINDING ON 150mm WELL COMPACTED HARDWARE.

DRAINAGE:

KITCHEN WASTES TO SVP VIA DEEP SEAL TRAP.
BATHROOM WASTES TO S.V.P. VIA DEEP SEAL TRAPS. PROVIDE RODDING ACCESS.
ALL NEW INTERNAL PIPES ON EXTERNAL WALLS TO HAVE APPROVED INSULATION.
ALL NEW DRAINS TO BE 100mm DIA. APPROVED UNDERGROUND P.V.C. FLEXIBLY JOINTED WITH 150mm SURROUND GRANULAR FILL.
ALL NEW DRAINS TO HAVE MIN. 1:40 GRADIENT
THE DEPTHS OF THE FOUNDATIONS WILL BE GENERALLY 750mm TO THE BOTTOM OF THE FOUNDATION, AND SHALL BE DETERMINED BY THE PROXIMITY OF UNDERGROUND DRAINAGE OR THE PRESENCE OF TREES AND VEGETATION. FOUNDATIONS SHALL BE PLACED BELOW THE LEVEL OF ADJACENT DRAINS. WHERE TREES OR MAJOR VEGETATION EXIST NEAR THE EXCAVATIONS THEN THE FOUNDATION DEPTH WILL BE CALCULATED USING A RECOGNISED GUIDE TO ESTABLISH THE POTENTIAL FOR THE DAMAGE DUE TO ROOT ACTIVITY, AND TO ALLOW FOR SEASONAL GROUND MOVEMENT.

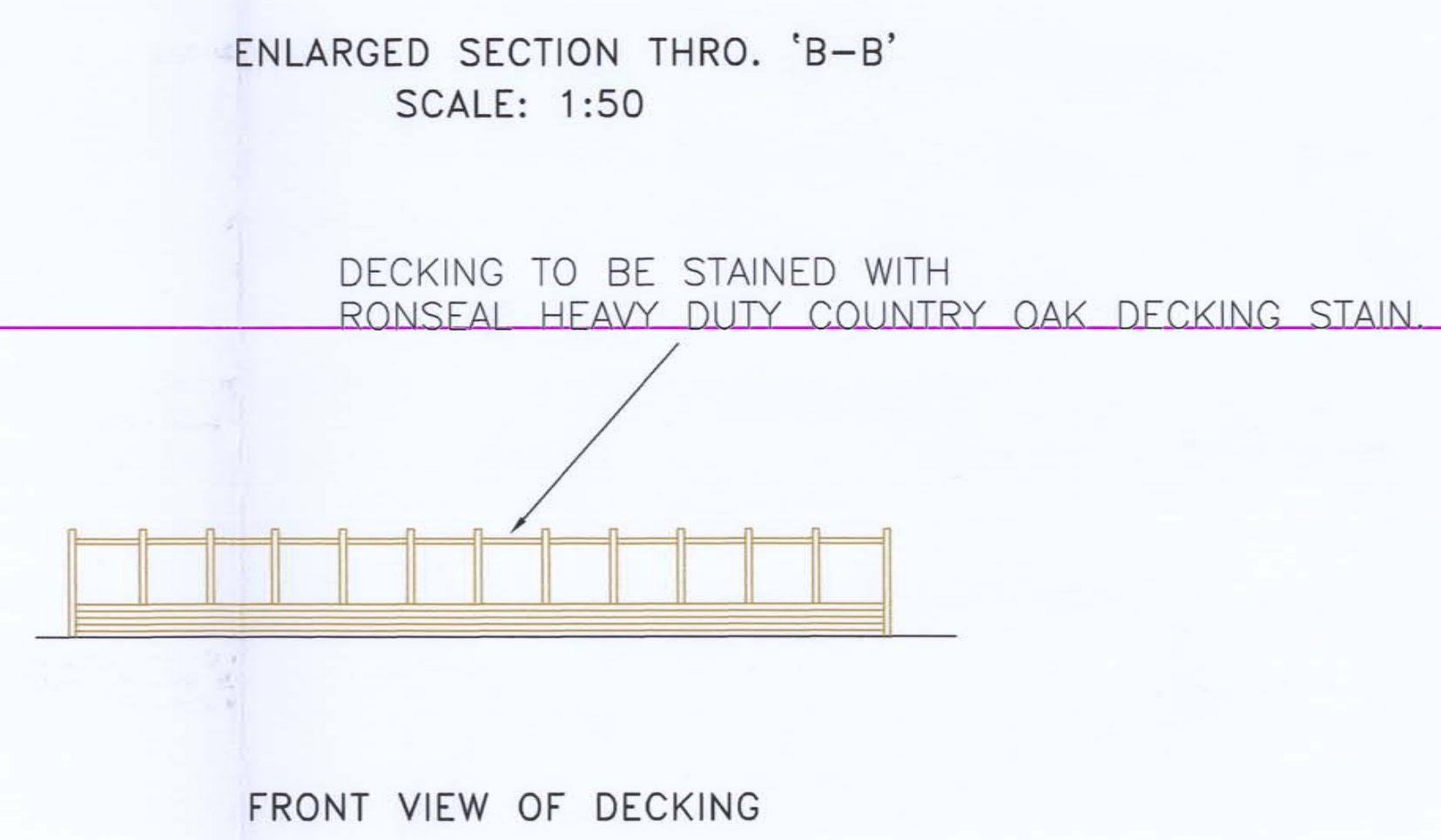
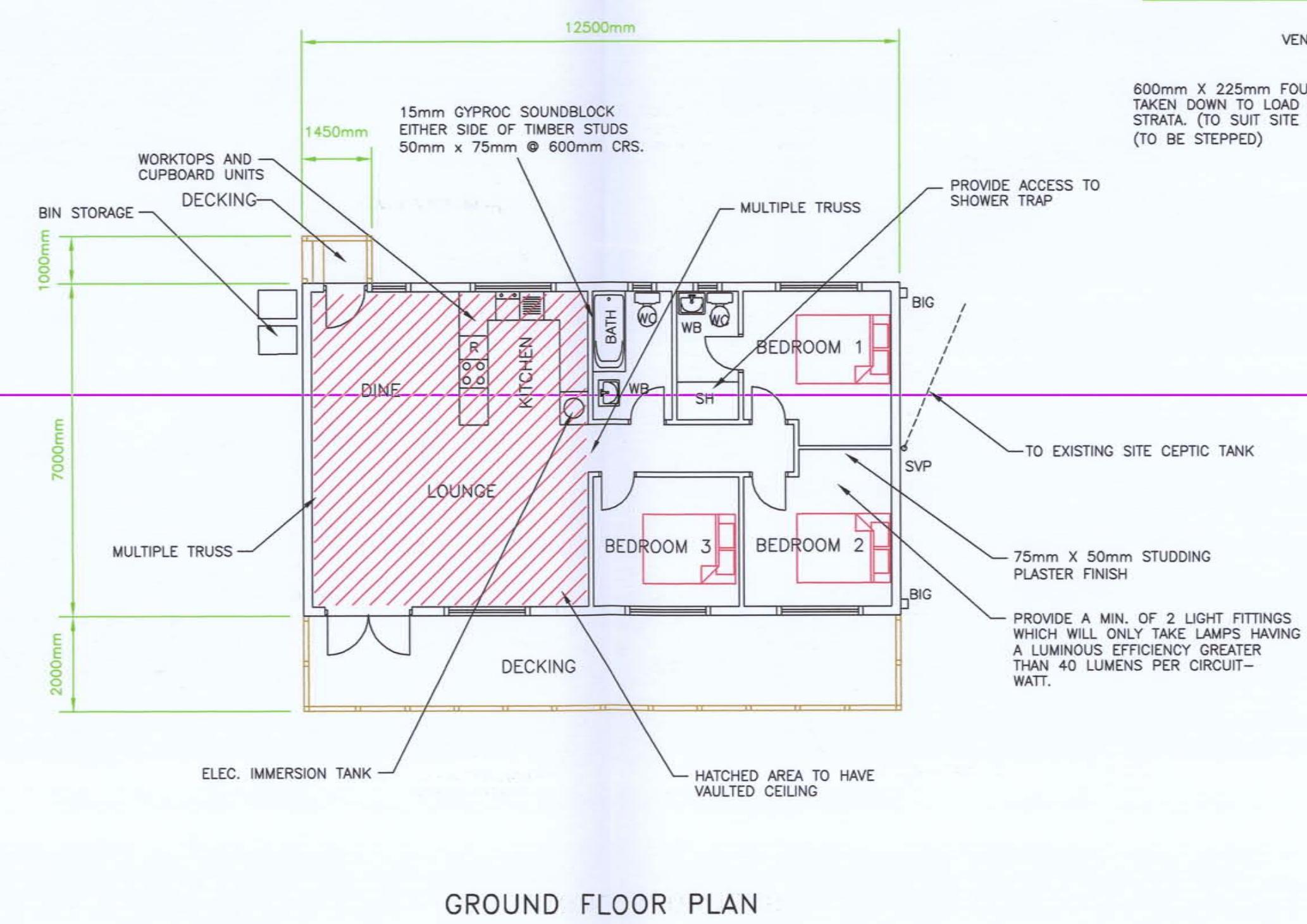

POSITION OF ALL EXISTING UTILITIES TO BE CHECKED ON SITE BEFORE BUILDING

