

Typical deck construction plan - Scale 1:20

- KEY:**
- Unplanted substrate
 - Whim plant communities
 - Dura Grating, stone grey, 50mm thick with 50mm mesh, 3 x 3m or 3 x 2m panels, supported by concrete blocks, filled with whinstone
 - Timber decking
 - Charcoal, 'Woodvale' grey textured flags (450 x 450 x 70mm)
 - Timber retaining detail (see SIL-GK-00-ZZ-DR-4302)
 - Timber bench (see SIL-GK-00-ZZ-DR-4302)
 - Steel mesh balustrade
 - Natural stone boulders
 - Relative height in metres above a standard finished level, defined by the total depth of the insulation layer, drainage layer and 150mm depth of growing medium above the top level of the concrete roof slab
 - External fire alarm beacon & sounder mounted on top of sleeper retaining wall
 - Low level down lighters recessed into timber edging

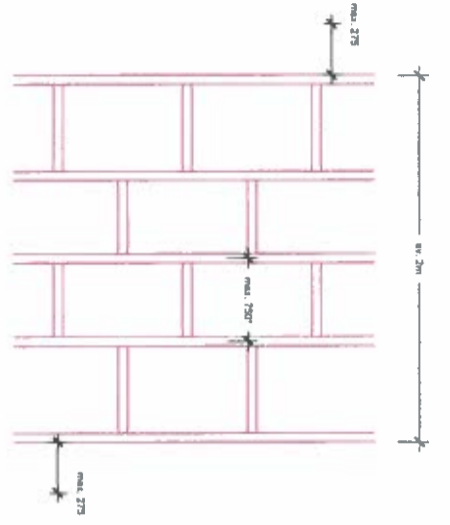

NOTE: When steel boulders are not craning at 60° across joints, the spacing of the joints must not exceed 750mm when measured along the top edge of the concrete roof slab. The height of the growing medium must be 150mm above the top level of the concrete roof slab. The height of the growing medium must be 150mm above the top level of the concrete roof slab. The height of the growing medium must be 150mm above the top level of the concrete roof slab.

- NOTES:**
- For decking and deck frame specification, see SIL-GK-00-ZZ-DR-4302.
 - Green roof drainage layer to be 'Roofdrain' by Agg Ltd. or similar.
 - Roofdrain 40 (50mm thick) to be used throughout.

| Activity/Phase | From/To | Level of Risk | Control Measures | Date of Assessment |
|--------------------------------|--------------|---------------|--|--------------------|
| Site preparation | 0.00 to 0.05 | Low | Standard control measures for site preparation. | 08/15 |
| Installation of substrate | 0.05 to 0.10 | Low | Standard control measures for substrate installation. | 08/15 |
| Installation of insulation | 0.10 to 0.15 | Low | Standard control measures for insulation installation. | 08/15 |
| Installation of drainage layer | 0.15 to 0.20 | Low | Standard control measures for drainage layer installation. | 08/15 |
| Installation of growing medium | 0.20 to 0.25 | Low | Standard control measures for growing medium installation. | 08/15 |
| Installation of decking | 0.25 to 0.30 | Low | Standard control measures for decking installation. | 08/15 |
| Installation of balustrade | 0.30 to 0.35 | Low | Standard control measures for balustrade installation. | 08/15 |
| Installation of seating | 0.35 to 0.40 | Low | Standard control measures for seating installation. | 08/15 |
| Installation of water taps | 0.40 to 0.45 | Low | Standard control measures for water tap installation. | 08/15 |
| Installation of cable fence | 0.45 to 0.50 | Low | Standard control measures for cable fence installation. | 08/15 |
| Final site inspection | 0.50 to 0.55 | Low | Standard control measures for final site inspection. | 08/15 |

BEACON
LIGHT FITTING

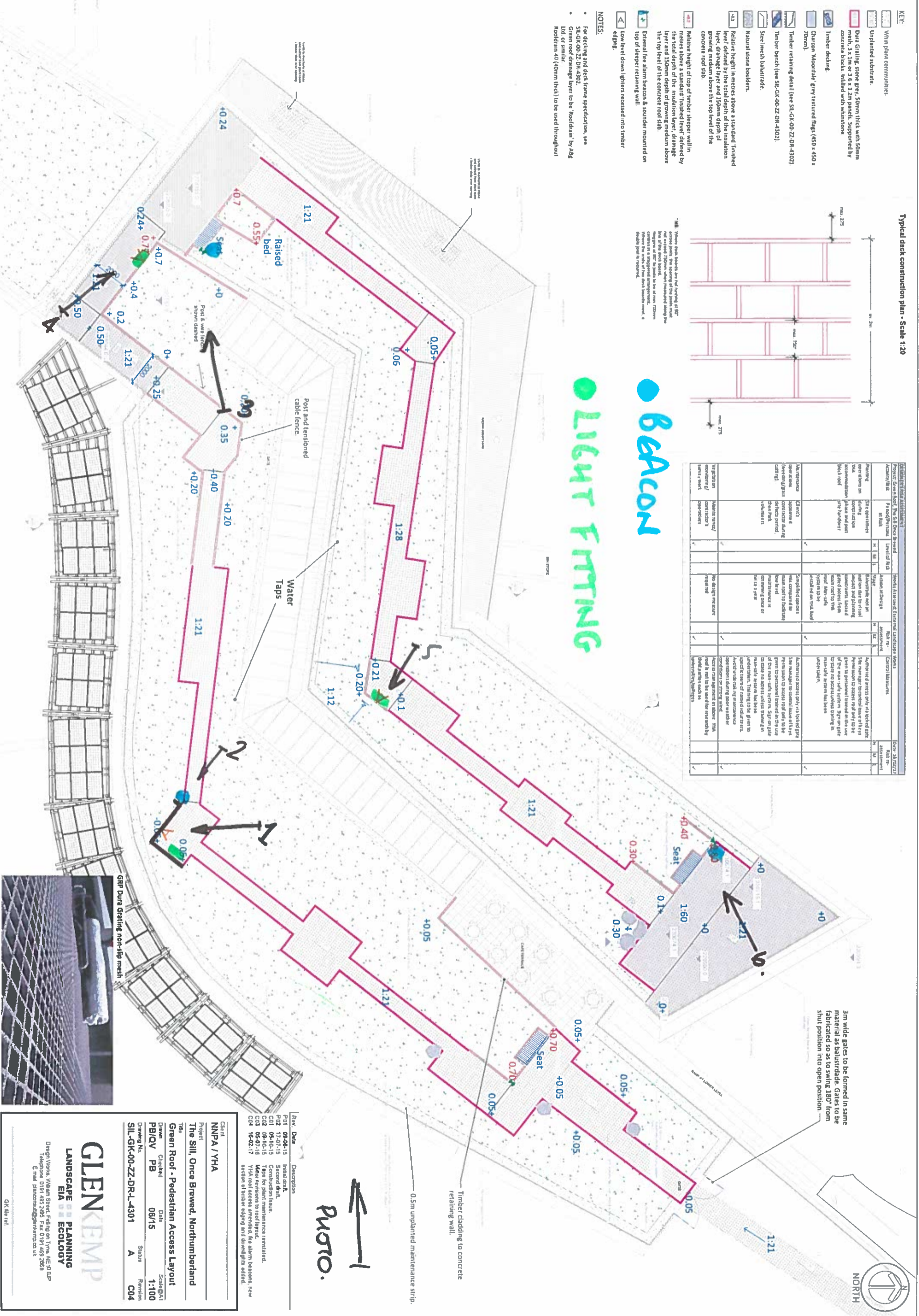

Client: NNPA / YHA
Project: The Sill, Once Brewed, Northumberland
Title: Green Roof - Pedestrian Access Layout
Drawn: PB
Checked: PB
Date: 08/15
Scale: 1:100
Revision: C04
Drawing No.: SIL-GK-00-ZZ-DR-4301
Status: A

| Rev. | Date | Description |
|------|----------|---|
| P01 | 08-06-15 | Initial draft. |
| P02 | 17-07-15 | Second draft. |
| C01 | 09-10-15 | Construction issue. |
| C02 | 09-10-15 | Tags for plant maintenance issued. |
| C03 | 09-10-15 | Many revisions to roof layout. |
| C04 | 16-02-17 | Typical roof access amended, see alarm beacon, new section of timber edging and drainage added. |

GLENKEMP
LANDSCAPE PLANNING
EIA & ECOLOGY
 Design Works, Walsam Street, Felling-on-Tyne, NE10 6AP
 Telephone 0191 455 2495 Fax 0191 459 2668
 E mail glen.kemp@glenkemp.co.uk
 GK-161616