

Red Hall, Elsdon, NE19 1BH.

LOCATION PLAN, PROPOSED CARAVAN

12/12/2016.

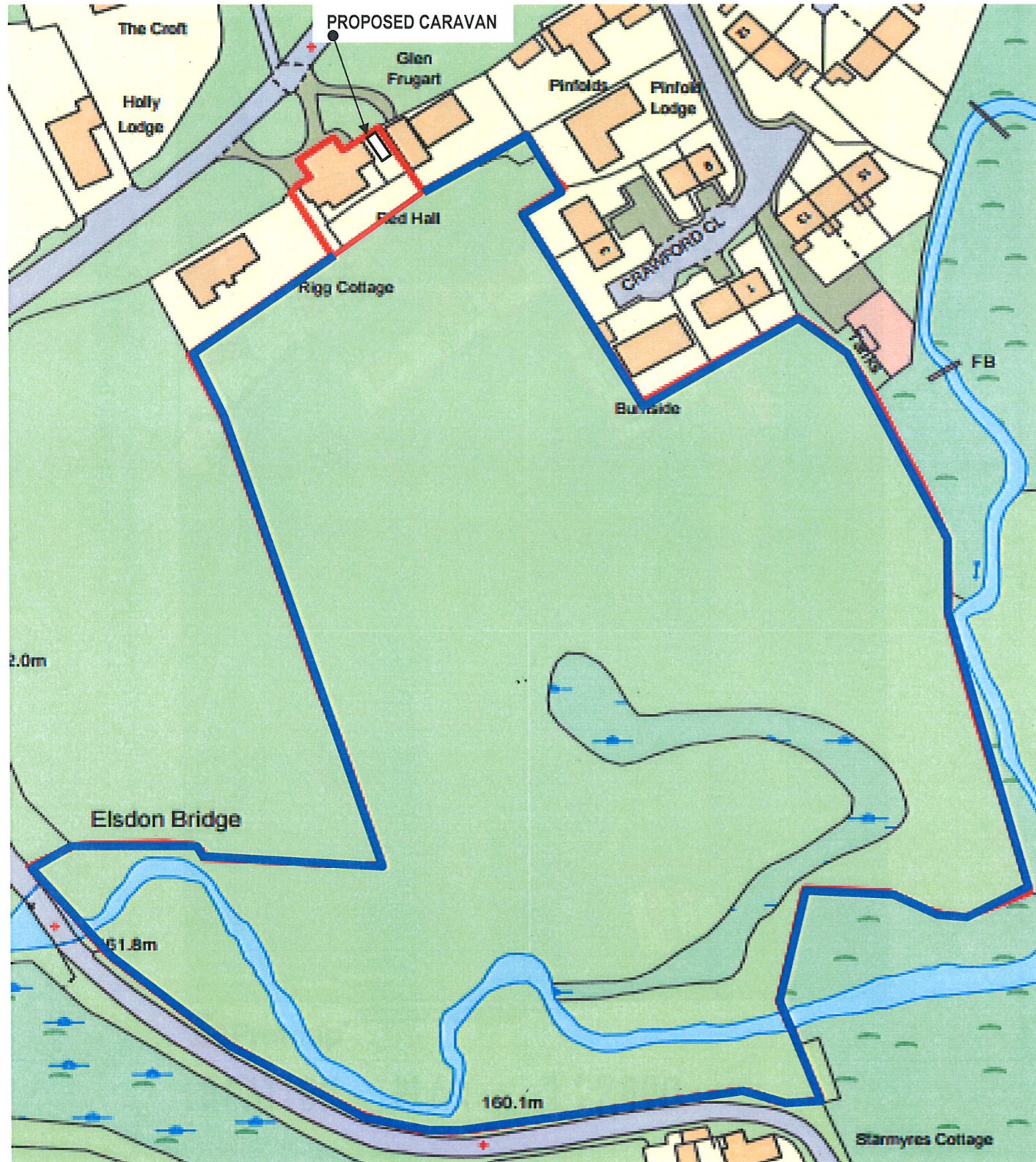

Location Plan 1:1250

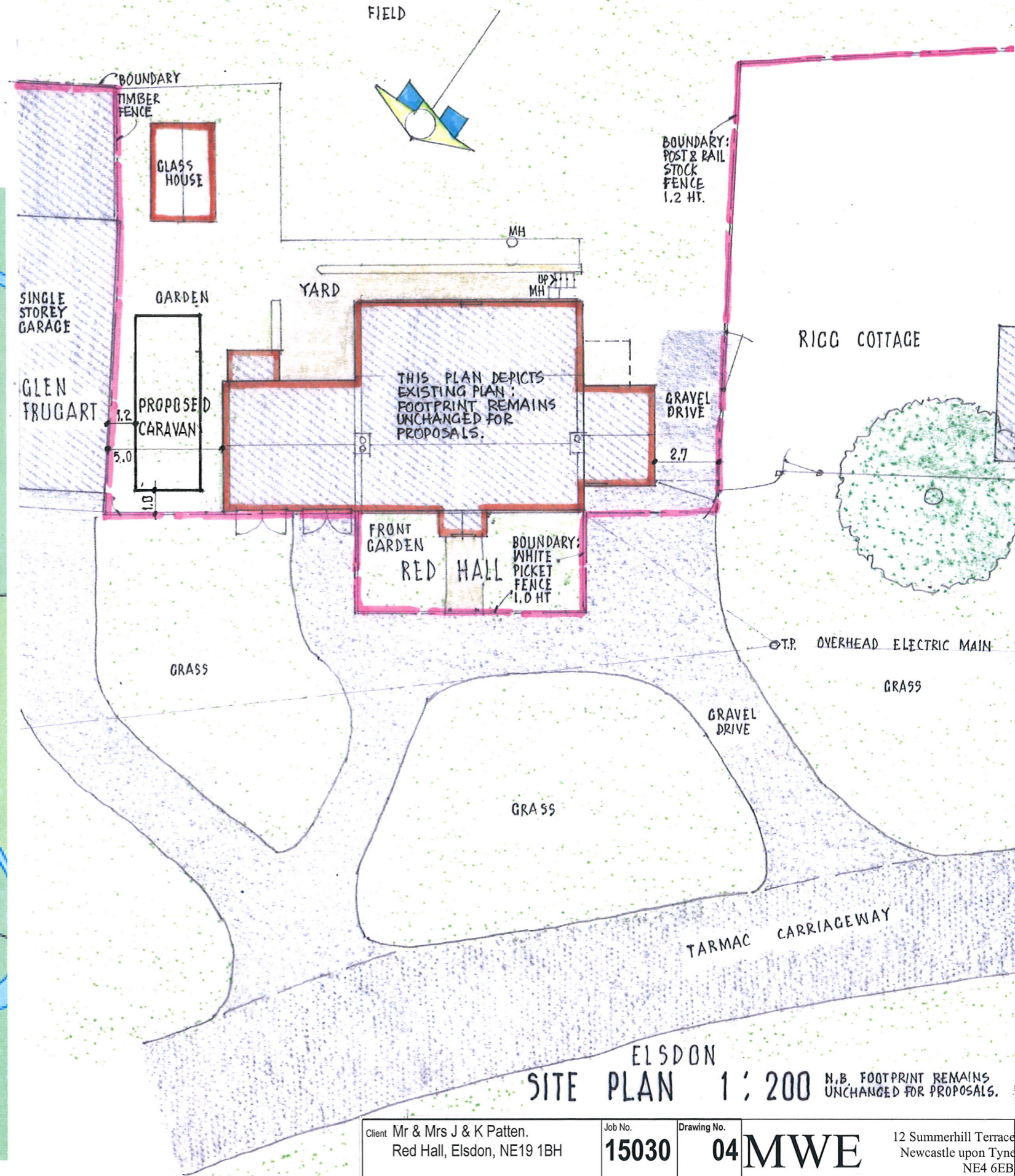

ELSDON
SITE PLAN 1:200 N.B. FOOTPRINT REMAINS UNCHANGED FOR PROPOSALS.

Client	Mr & Mrs J & K Patten. Red Hall, Elsdon, NE19 1BH	Job No.	15030	Drawing No.	04		12 Summerhill Terrace Newcastle upon Tyne NE4 6EB
Project	HOUSE REDEVELOPMENT	Scale	As shown	Date	01-11-16		Tel. 0191 2602299 Fax. 0191 2603340
LOCATION PLAN, SITE PLAN: PROPOSED CARAVAN		Drawn by	FTH	Chartered Architects		CDM Co-ordinators	
		Approved by	FTH	Project Managers		Town Planning Consultants	

THIS DRAWING IS COPYRIGHT.