

**LOCATION PLAN**  
SCALE 1:2,500

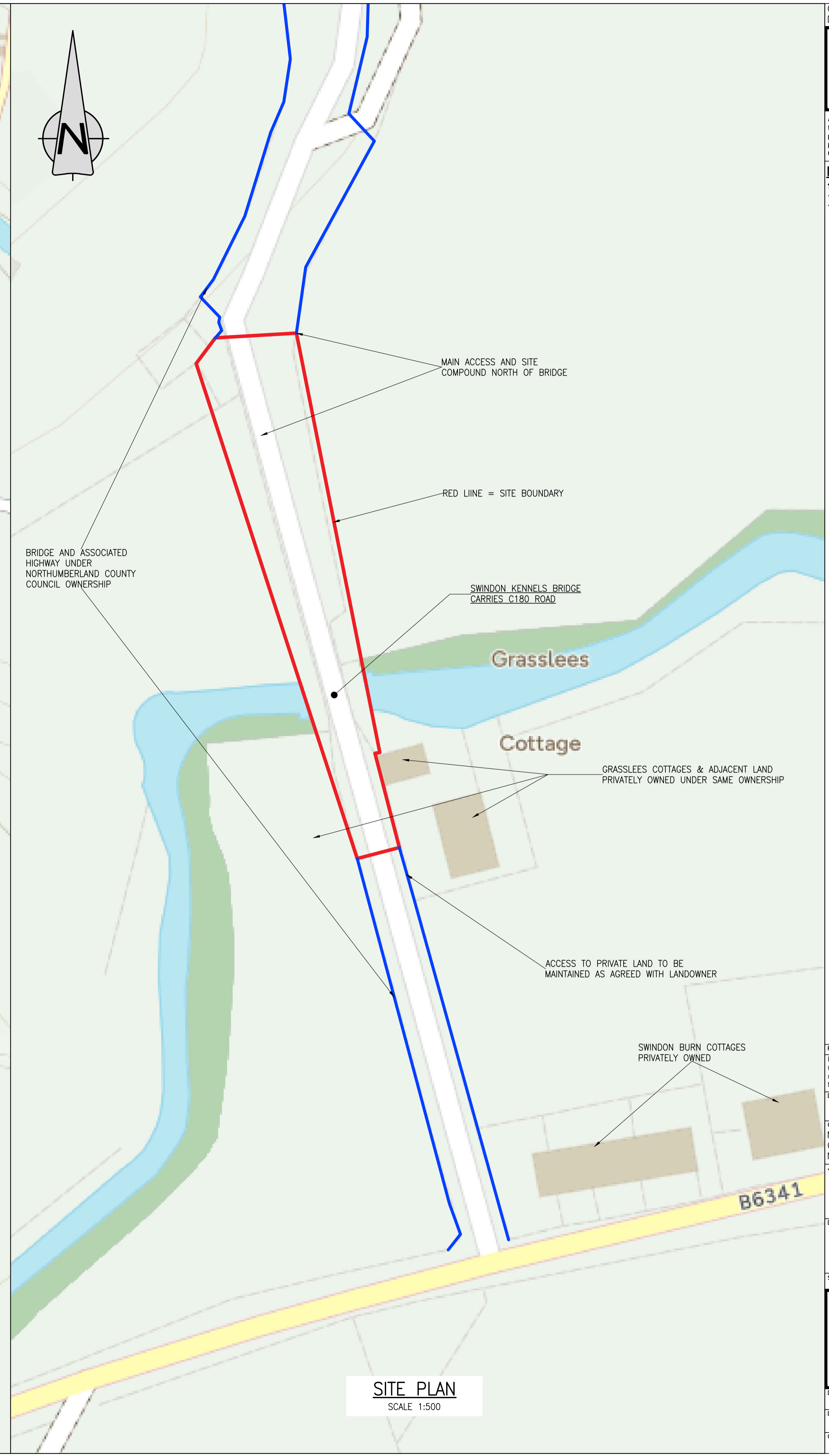

**SITE PLAN**  
SCALE 1:500

All rights reserved. No part of this document may be reproduced in any material form (including photocopying or storing in any medium) without the written permission of Northumberland County Council except in accordance with the provisions of Copyright, Designs and Patents Act 1988. Unauthorised reproduction may lead to prosecution or civil proceedings.

- NOTES:**
1. **GENERAL**
  - 1.1. ALL DIMENSIONS IN [mm] UNLESS STATED OTHERWISE.
  - 1.2. ALL LEVELS IN [m] IN REFERENCE TO GPS CO-ORDINATE SYSTEM.

Revision:	By:	Chk.:	App.:	Date:	Rev.:

Reproduced from based upon the Ordnance Survey mapping with permission of the Controller of Her Majesty's Stationery Office. © Crown copyright. Unauthorised reproduction infringes Crown copyright and may lead to prosecution or civil proceedings. NORTHUMBERLAND COUNTY COUNCIL - O.S. License No. 100049048 (2009)

Drawing Status: **PRELIMINARY**

Client: NORTHUMBERLAND COUNTY COUNCIL  
COUNTY HALL, MORPETH  
NORTHUMBERLAND, NE61 2EF

Job Title: **SWINDON KENNELS**

Drawing Title: **SITE AND LOCATION PLAN**

Scale(s): AS SHOWN

Drawn: IH	Date: Apr '24	Checked: SR	Passed: PS
Drawing Number: HB187325/B/C180/01/03	Revision:		
Oracle Number: HB187325			

File Path: C:\Users\Siddiqur.Rahman\OneDrive - WSP\_0365\Desktop\MCC\Tarsel Type\CAO SK Location Plan\HB187325-B-C180-00-03 SWINDON KENNELS LOCATION PLAN