

Traditional Timber Walls & Floor

Walls:	Floor:
18mm Cedar Cladding	8mm Oak or Grey Oak Effect Laminate Flooring
38mm x 28mm Tile Batten	2mm Foam Underlay
Breathable Weather Membrane	18mm Water Resistant Chipboard Flooring
4x2 CLS Stud Walling	6x2 Treated Timber Floor Joists
75mm Knauf/Rockwool Earth – Acoustic Insulation – Between Joists	75mm Knauf Earth – Acoustic Insulation – Between Joists
25mm Kingspan/Celotex Insulation To Inner Studs	25mm Kingspan/Celotex Insulation – Between Joists
9.5mm Plasterboard	40mm x 40mm x 3mm Galvanized Angled Steel
2-3mm Plaster	4" x 4" Steel Plate
18mm MDF White Skirting Boards	Concrete Surrounds

Use of materials and types.

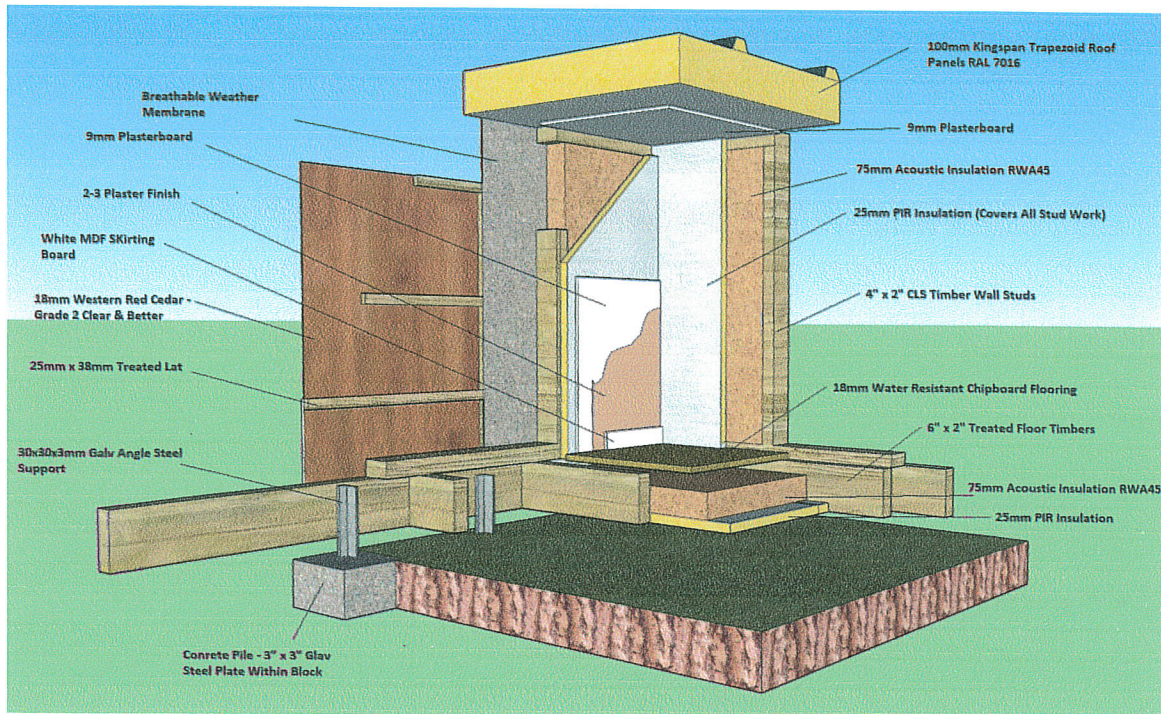

Dark Grey PVC-u Doors & Windows

Each Oeco garden room is fitted with as standard with our high-quality PVC-u Windows & Doors. The position of the doors and windows is at the discretion of the customer. All doors and windows are supplied double glazed with PVC-u anthracite wood grain effect on the outside and white on the inside. All doors and windows are fitted with low-E solar, energy efficient insulated Planitherm clear glass as standard complete with warm edge super spacer bars.

Each door and window has been designed and tested to achieve the highest levels of security. The patio doors are fitted with the award-winning Yale high security multi-point locking systems to give your garden room maximum protection and to satisfy the requirements for your home contents insurance cover.

