

ALL DIMENSIONS ARE IN mm UNLESS NOTED OTHERWISE  
 N.G.R E: 400901 N: 616501  
 CONCESSION REQUIRED NO

NOTES:

Northumberland National Park  
 Authority  
 Planning Department  
 23 APR 2019  
 Received

REV	MODIFICATION	BY	CH	DATE
D	Layout Updated	KS	-	01.04.19
C	Layout Revised, Grillage Added	KS	-	08.03.19
B	Compound repositioned & layout revised	DP	DW	13.11.18
A	Issued for Approval	DP	PC	26.07.18

**CLARKE telecom**  
 Unit E, Madison Place, Northampton Road,  
 Manchester, M40 5AG  
 Tel: 0161 785 4500  
 Fax: 0161 785 4501  
 Web: www.clarke-telecom.com

**AIRWAVE**  
 Airwave Solutions Ltd  
 Charter Court, 50 Windsor Rd, Slough, Berkshire, SL1 2EJ.

**NEC**

SEGMENT REF.	SITE CODE
KXR793	NHU994

Site Name	Opt.
KNOCK HILL	-

Site Address / Contact Details  
 KNOCK HILL  
 LAND TO THE NORTH  
 OF CAR PARK  
 NEAR BRANDON  
 NE66 4LT

Drawing Title:		PROPOSED SITE PLAN	
Purpose of Issue:		PLANNING	Dwg Rev:
Drawing Number:		200	D
Surveyed By:	SSH	Original Sheet Size:	A3
Drawn:	DP	Date:	26.07.18
Checked:	PC	Date:	26.07.18
Pack Issue:	E		

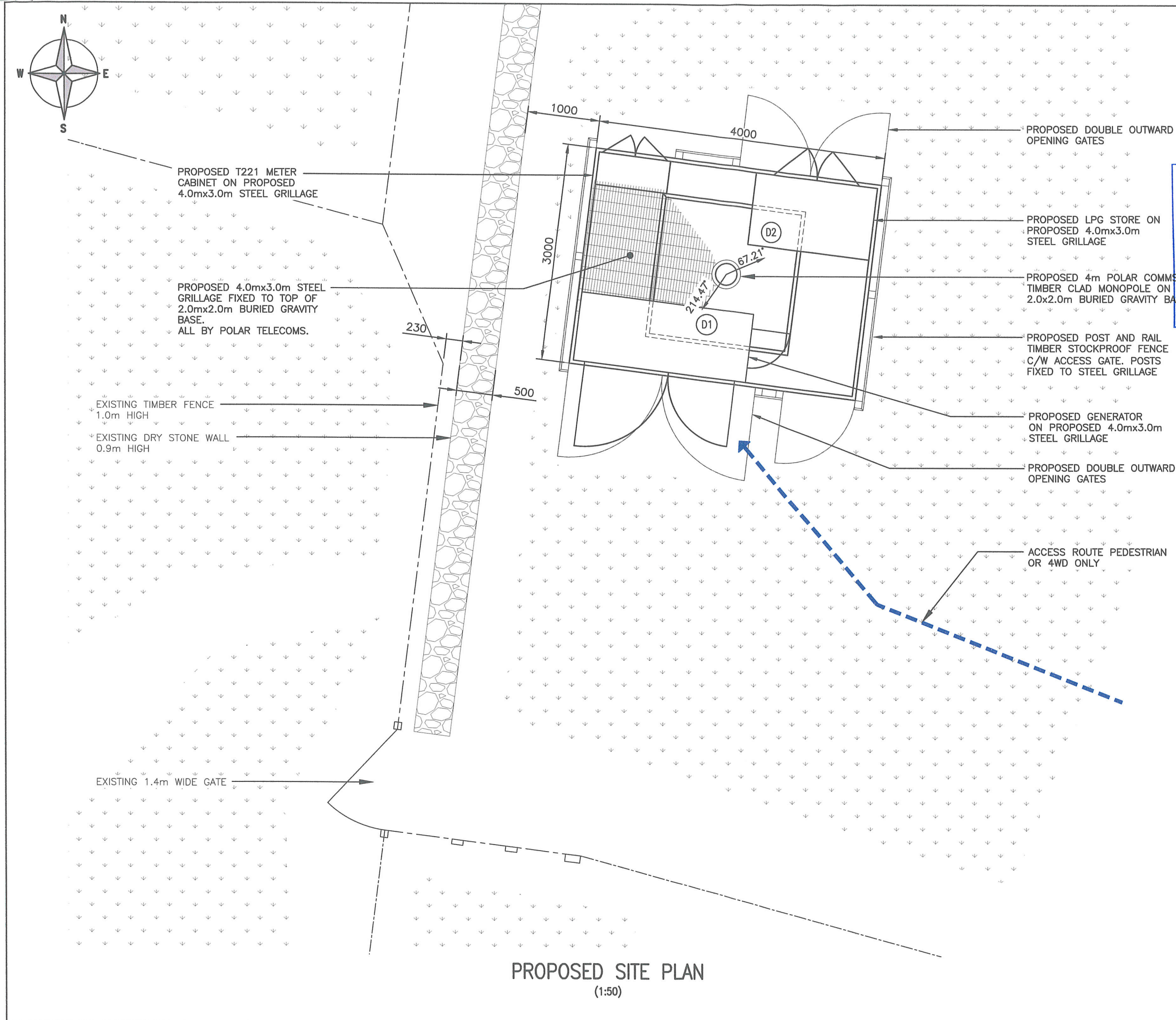

PROPOSED SITE PLAN  
 (1:50)