



QUIET, WARMTH & STYLE

 **GRANADA**
secondary glazing

Traditional Product Range

Tilt-In Balanced Vertical Slider (TBVS)

Discreet units with self-supporting panes. Tilt-in facility enables each secondary sash (panel) to be independently released from the outer frame and pivoted inwards through almost 180°.

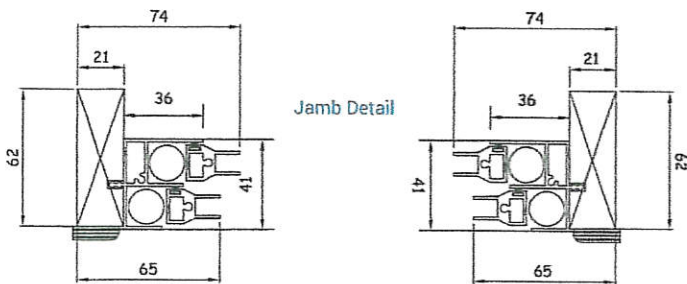

Head Detail

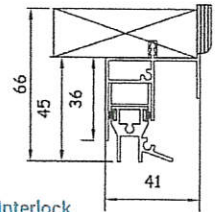

Interlock

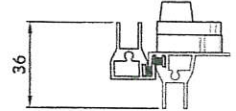

Cill Detail

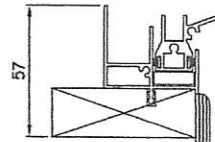

Features

- Slim, unobtrusive aluminium profile
- Smooth sliding action utilising spring balances to ensure ease of use and to support the weight of panel
- Both panels tilt-in to allow easy access for cleaning and maintenance
- Improved noise and thermal installation
- Suitable for arched applications (please note: top panel won't tilt)
- Suitable to have bevelled timber subframe to fix in to bays / splayed reveals
- Can be coupled or stacked with other units in the range to treat large areas of glazing or long runs of windows

Variations of Basic Unit

- Goal post subframe and aluminium available
- Locking Fitch Catch available
- Standard and acoustic trickle vents are available
- Tilt-in balanced vertical slider can be coupled and stacked using a heavy duty frame coupling section or timber to timber
- Larger trims and timber trims available at additional costs
- Variety of stock colours available, including all RAL options
- Can accept flyscreen mesh

Specification

- Glazing options: 4mm - 6.8mm
- Choice of timber subframes
- Pre-drilled and countersunk to suit either face fix or reveal fix
- Woolpile inserted in to panel section groove to create outer frame seal
- Gasket colour option of black or white
- PVCu trims supplied for the face of the units to create a neat, clean finish
- Standard colour white high gloss - RAL 9910
- Fitch catch located centrally on mid rail

Traditional Configurations

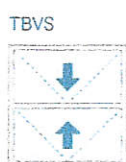

Based on 4mm Glass

Max width: 1,500mm
or Max height: 3,000mm



Optimum Noise Reduction: 48dB (Rw)

Using 6.4mm acoustic laminate glazing, with 200mm glass-to-glass



Optimum U Value: 1.868 W/m2K

Using 4mm toughened Low E glazing, with 80mm glass-to-glass

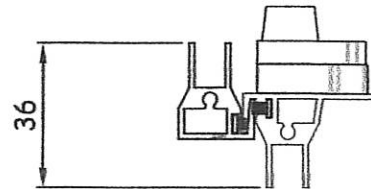
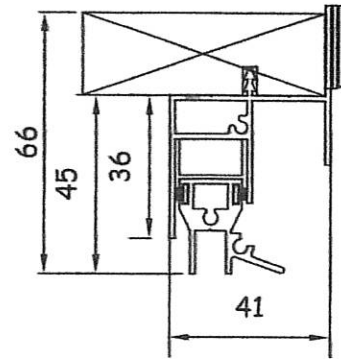
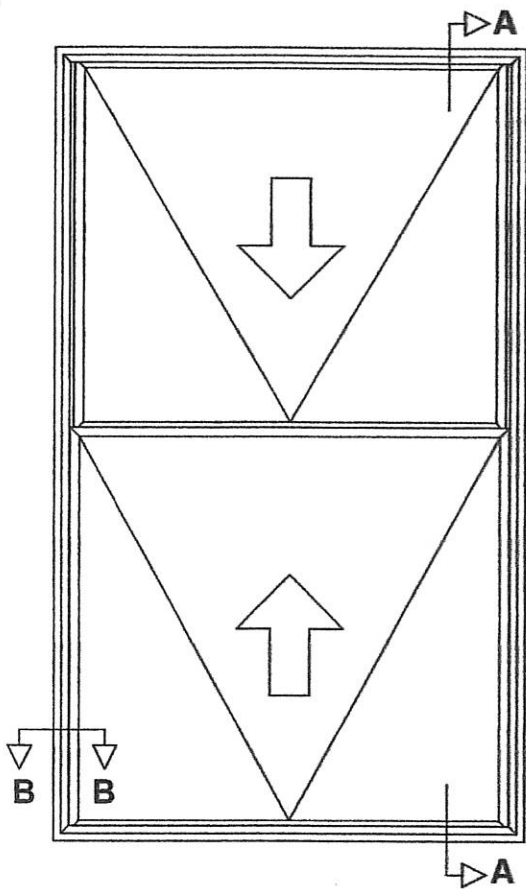

Section A-A

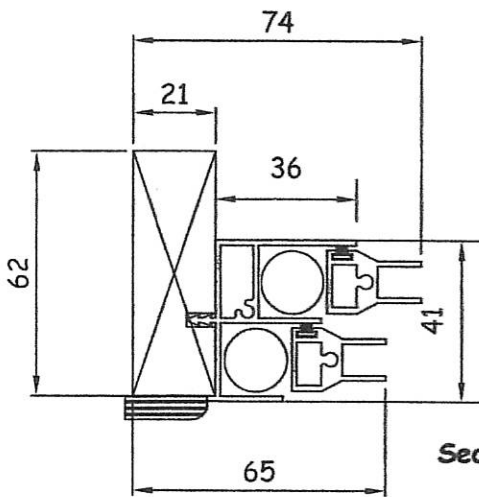
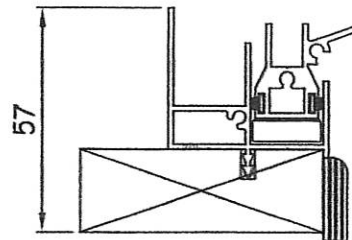

Section B-B

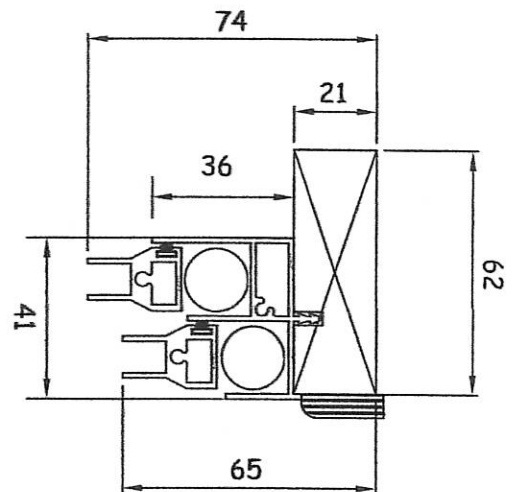

Standard Product Specification:

Aluminium 6063T6 alloy to BS EN 755 standard, powder coated to BS 6496 to 60 micron finish.

Stock finish: White - Interpon SA 098E high gloss. The sub-frame is manufactured from primed high quality, environmentally certified (MTCS) engineered timber. Standard sizes Reveal Fix: 62mm x 21mm & Face Fix: 45mm x 21mm.

All frames are factory glazed.
Standard gasket colour is black.

All frames include pvc-u trim as standard - Painted MDF or PEFC timber available upon request.

In line with our company policy of continuous product development and improvement, Granada reserves the right to make minor alterations to specification without notice.

Optional Extras

- Locking fitch catch
- White gasket
- Aluminium coupling mullion
- Stacking interlock transom
- Trickle vents / acoustic trickle vents
- RAL colours
- Flyscreen
- Timber sizes other than standard available on request



Campbell Way
Dinnington
Sheffield
S25 3QD