

All rights reserved. No part of this document may be reproduced in any material form (including photocopying or storing in any medium) without the written permission of Northumberland County Council except in accordance with the provisions of Copyright, Designs and Patents Act 1988. Unauthorised reproduction may lead to prosecution or civil proceedings.

NOTES:

- GENERAL**
 - ALL DIMENSIONS IN [mm] UNLESS STATED OTHERWISE.
 - ALL LEVELS IN [m] IN REFERENCE TO GPS CO-ORDINATE SYSTEM.

- EXISTING STRUCTURE**
 - REDMIRE BRIDGE IS A 3No. 8.5m SPAN, 5.4m WIDE, MASONRY ARCH BRIDGE CARRYING THE C199, A SINGLE LANE TWO WAY CARRIAGEWAY OVER TARGET.
 - THE PROPOSED STRUCTURE IS THE INSTALLATION OF A CONCRETE SADDLE TO THE ARCHES. WORKS TO BE UNDERTAKEN FROM THE CARRIAGEWAY WITH THE ARCH BARRELS ACTING AS PERMANENT FORMWORK.

- ESURFACING**
 - CARRIAGEWAY SHOULD BE LAID TO LINE AND LEVELS DETAILED ON THE DRAWING.
 - CONSTRUCTION SHALL COMPRISE: 40mm HRA 30/14 F SURF 40/60 SURFACE COURSE ON TOP OF MIN. 60 AC20 HDI BIN 40/60 BINDER COURSE.
 - SURFACE IRREGULARITY, ROLLING STRAIGHT EDGE IN ACCORDANCE WITH SPECIFICATION FOR HIGHWAY WORKS CLAUSE 702 AND TRRL SR 290.
 - BITUMINOUS ANALYSIS PARTICLE SIZE DISTRIBUTION TO BS EN 12687-1-2012.
 - DENSITY (SDG 200 DENSITY METER) MAX. REFUSAL DENSITY.
 - TEXTURE DEPTH VOLUMETRIC PATH TEST TO BS EN 13036-1-2010.

- STRUCTURAL CONCRETE**
 - ALL CONCRETE SHALL BE CLASS NCC/1 UNLESS STATED OTHERWISE.
 - CONCRETE FINISHES TO BE F4 & U2IN ACCORDANCE WITH SPECIFICATION FOR HIGHWAYS WORKS SERIES 1700 CLAUSE 1708.

- CONCRETE CONFORMANCE TESTING**
 - ALL CONCRETE POURS ARE TO BE TESTED BY MEANS OF 4No. CUBES.
 - TWO CUBES ARE TO BE TESTED AFTER 7 DAYS OF CURING, ONE SITE BASED, ONE CURED IN THE LABORATORY.
 - TWO CUBES ARE TO BE TESTED AFTER 28 DAYS OF CURING, ONE SITE BASED, ONE CURED IN THE LABORATORY.
 - COPIES OF THE RESULTS ARE TO BE MADE AVAILABLE TO THE ENGINEER UPON RECEIPT. APPROVAL TO PROCEED MUST BE SENT FROM THE ENGINEER.

- WATERPROOFING**
 - WATERPROOFING TO BE SPRAY APPLIED.
 - PREPARED CONCRETE FOR WATERPROOFING TO BE INSPECTED BY WATERPROOFING CONTRACTOR PRIOR TO WATERPROOFING APPLICATION.
 - CONTRACTOR TO CARRY OUT ELECTRONIC PINHOLE SURVEY TO DETECT PINHOLES AND MEMBRANE THICKNESS LESS THAN 2mm.
 - COMPLETION CERTIFICATE TO BE ISSUED DETAILING RESULTS OF THE SURVEY AND REMEDIAL ACTIONS TAKEN.

LEGEND

- BTu BT UNDERGROUND PLANT
 - W NWL PLANT THRUST BORED UNDER RIVER
- SERVICES SHOWN ARE IN INDICATIVE LOCATIONS. ACTUAL LOCATIONS TO BE CONFIRMED ON SITE PRIOR TO WORKS.

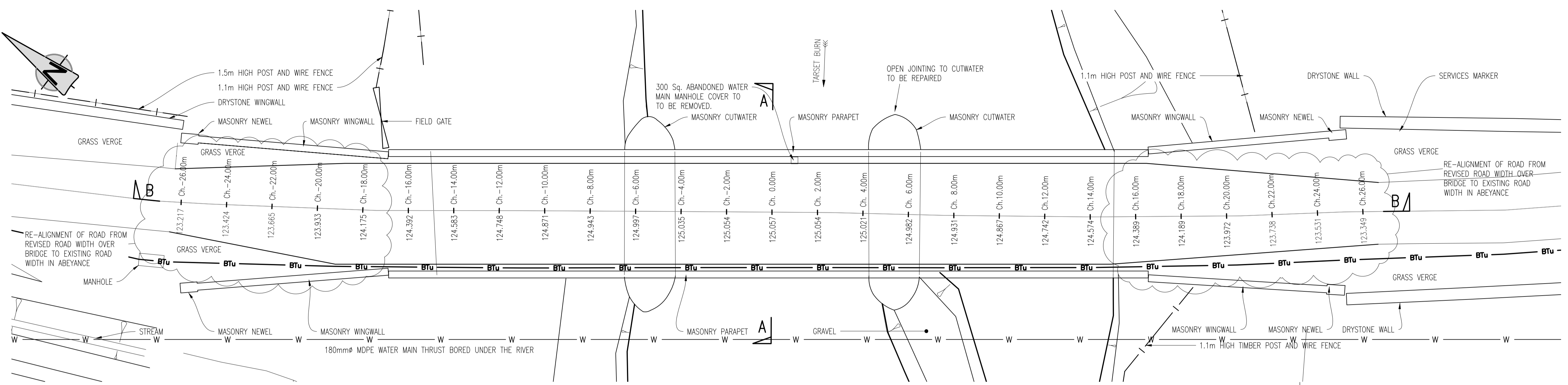

PLAN ON BRIDGE
SCALE: 1:100

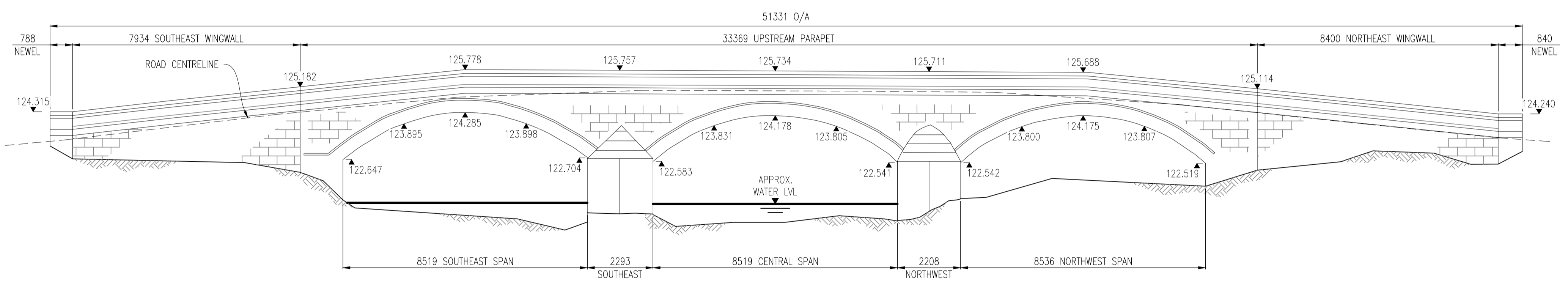

UPSTREAM ELEVATION
SCALE: 1:100

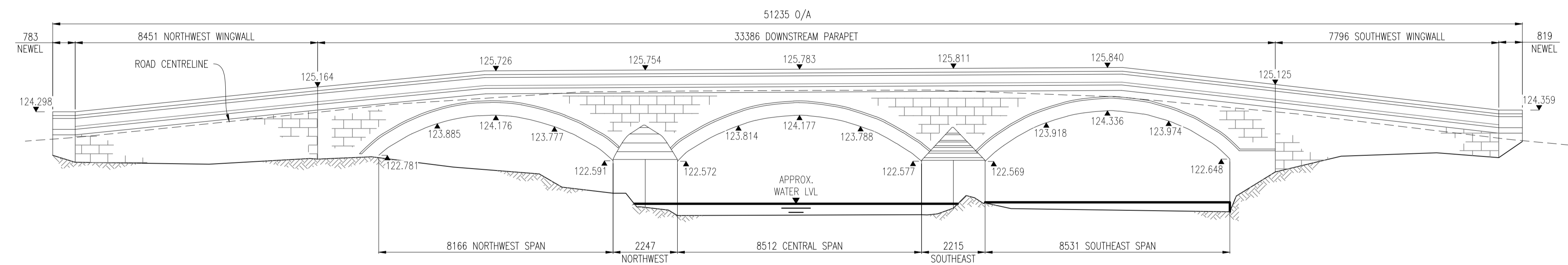

DOWNSTREAM ELEVATION
SCALE: 1:100

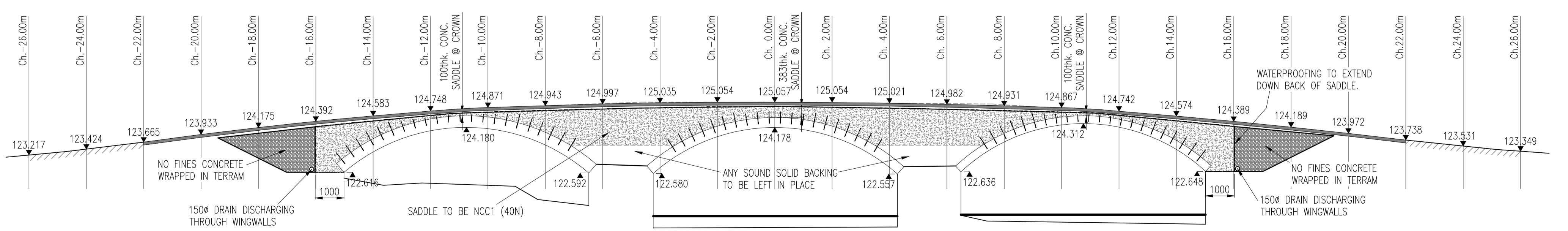

LONGITUDINAL SECTION B - B
THRO' CARRIAGEWAY CENTRELINE - SHOWING ARCH BARREL
THICKNESS CONFIRMED BY TRIAL PITS ON 5/12/16
SCALE: 1:100

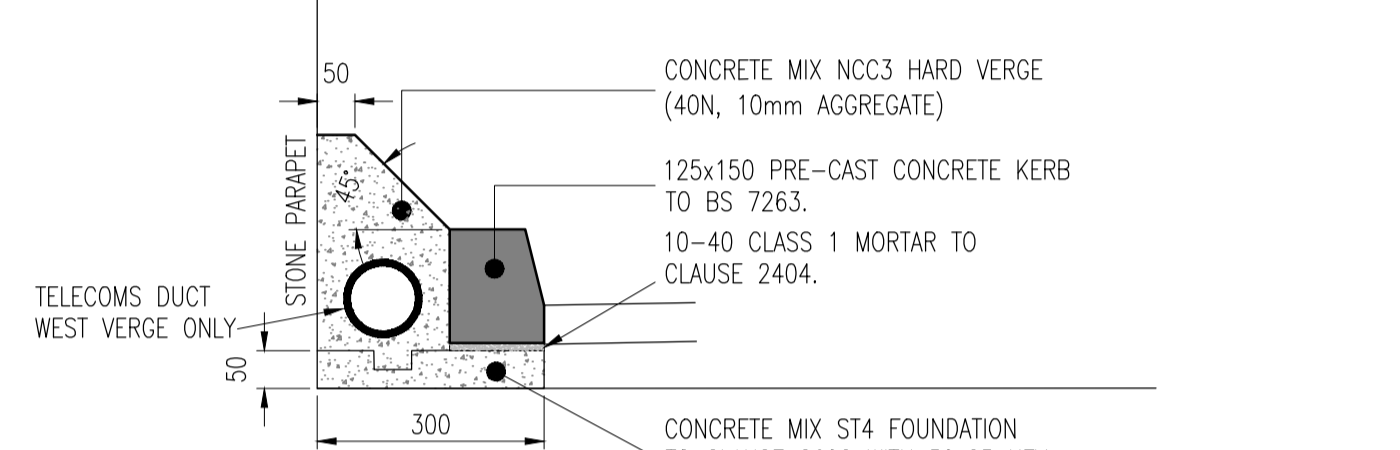

TYPE K20 KERB
(HALF BATTER KERB)
SCALE: 1:10

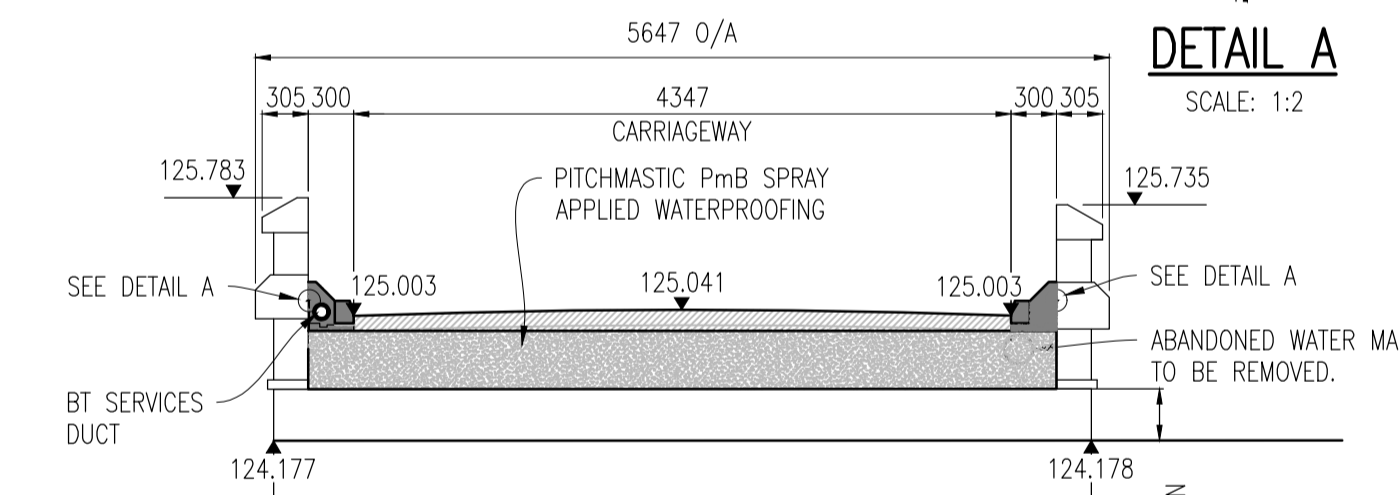

SECTION A - A
THRO' CENTRAL SPAN CROWN
SCALE: 1:50

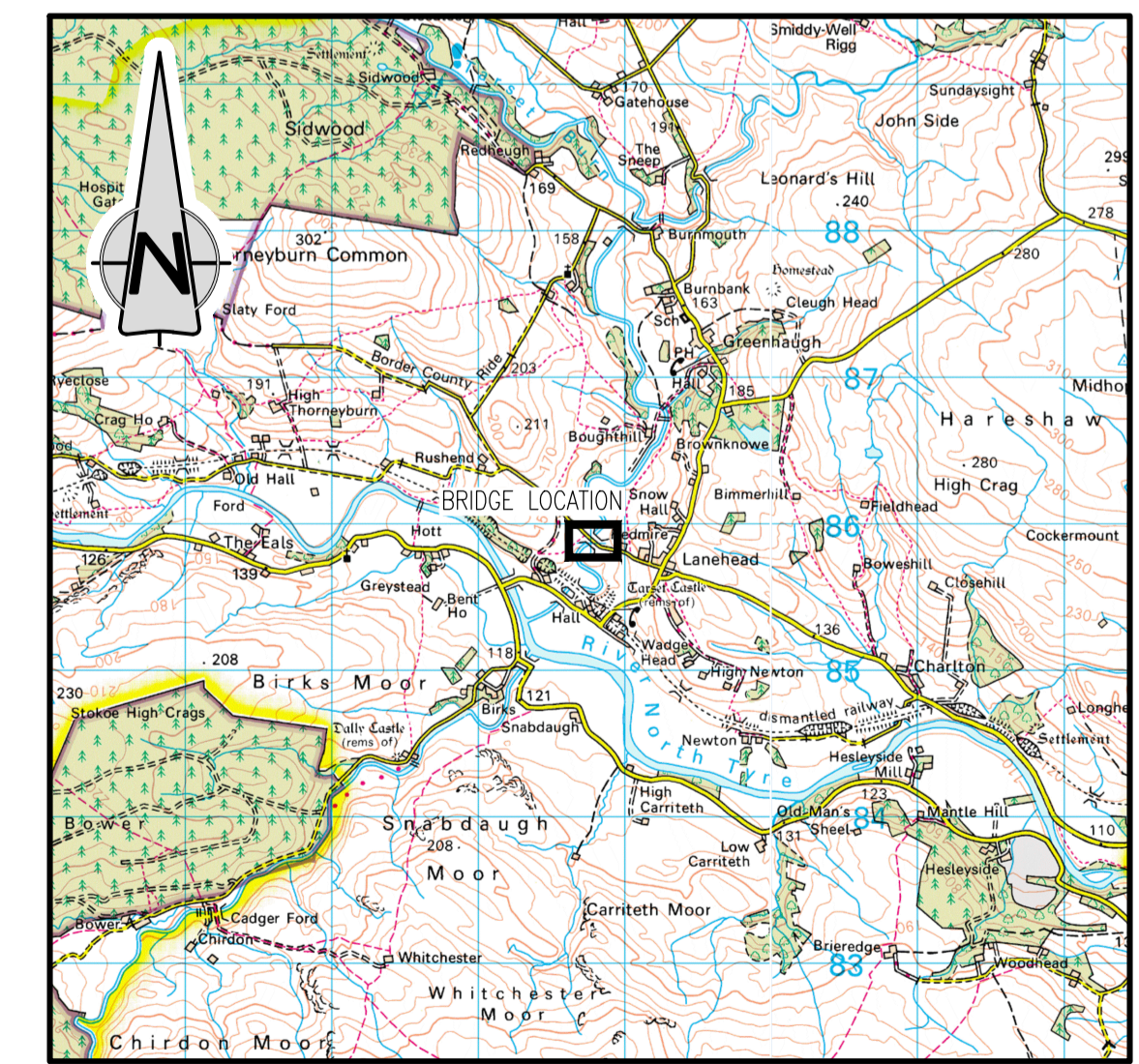

SITE REFERENCE PLAN
SCALE: 1:50,000

Revision:	By:	Chk:	App:	Date:	Rev:

Reproduced from based upon the Ordnance Survey mapping with permission of the Controller of Her Majesty's Stationery Office. © Crown copyright. Unauthorised reproduction infringes Crown copyright and may lead to prosecution or civil proceedings. NORTHUMBRIA COUNTY COUNCIL - O.S. License No 100049048 (2009)

Drawing Status: **PRELIMINARY**

Client: NORTHUMBRIA COUNTY COUNCIL
COUNTY HALL, MORPETH
NORTHUMBRIA, NE61 2EF

Job Title: **REDMIRE BRIDGE
C199/14
MASONRY ARCH REFURBISHMENT**

Drawing Title: **PROPOSED
GENERAL ARRANGEMENT**

Scale(s): **AS SHOWN**

Drawn:	Date:	Checked:	Passed:
JT	July 20		

Drawing Number: **HB177318/B/C199/14/02**
Revision:
Oracle Number: **HB177318**